

Code

RZC-NA2XFGBH

Voltage Rating

0.6/1 kV

Standard

TS IEC 60502-1, VDE 0276

IEC 60228

EN 61034

EN 50267

EN 60332-3

Conductor

Smoke Density

Halogen Free

Flame Retardant (Cat C)

Reaction to Fire Classification (CPR)

EN 60332-1-2

Flame Retardant

Conductor

Stranded Aluminum Conductor (Class 2)

Insulation

XLPE (Cross-linked Polyethylene)

Filler

Halogen Free Filler

Armour

Flat Steel Wire and Galvanized Steel Tape

Sheath

Halogen Free Sheath

Technical Data

Max. Operating Temperature

90°C

Short Circuit Temperature

250°C (max.5 sec)

Bending Radius

15D (D : Overall Diameter)

Test Voltage

3,5 kV

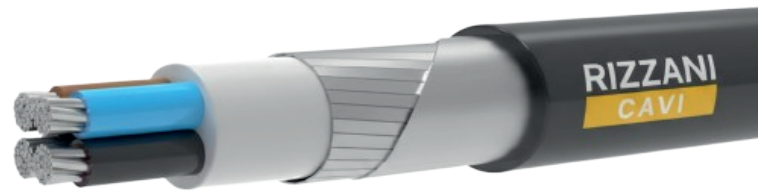

Application :

For installation indoors and outdoors, in cable ducts, underground, in power or switching stations, local energy distribution industrial plants, where there is no risk of mechanical damage. Suitable for comparatively high maximum permissible conductor temperature.



RIZZANI

CAVI

Nominal Cross Section (mm ²)	Overall Diameter (mm)	Net Weight (kg/km)	Delivery Length (m)	Resistance at 20°C (ohm/km)	Current Carrying Capacity	
					In the Ground at 20°C	In the Air at 30°C
1x50	17,5	579,8	1000	0,641	164	169
1x70	19,6	712,2	1000	0,443	201	214
1x95	21,1	842,7	1000	0,320	240	263
1x120	22,6	967,9	1000	0,253	272	308
1x150	25,0	1142,3	1000	0,206	303	349
1x185	27,2	1337,9	1000	0,164	340	401
1x240	29,8	1586,6	500	0,125	387	469
1x300	32,5	1901,4	500	0,100	430	535

Nominal Cross Section (mm ²)	Overall Diameter (mm)	Net Weight (kg/km)	Delivery Length (m)	Resistance at 20°C (ohm/km)	Current Carrying Capacity	
					In the Ground at 20°C	In the Air at 30°C
2x10	17,6	624,4	1000	3,08	-	-
2x16	19,6	760,5	1000	1,91	-	-
2x25	22,7	988,7	1000	1,20	113	104
2x35	24,8	1173,1	1000	0,868	136	128
2x50	27,7	1412,3	1000	0,641	159	152
2x70	32,1	1844,5	500	0,443	197	194
2x95	35,8	2285,6	500	0,320	236	239
2x120	39,1	2693,6	500	0,253	269	278
2x150	44,6	3385,0	500	0,206	302	316
2x185	49,3	4057,5	250	0,164	342	365
2x240	54,3	4899,4	250	0,125	397	430



ISTITUTO ITALIANO DEL MARCHIO DI QUALITÀ

RIZZANI

CAVI

Nominal Cross Section (mm ²)	Overall Diameter (mm)	Net Weight (kg/km)	Delivery Length (m)	Resistance at 20°C (ohm/km)	Current Carrying Capacity	
					In the Ground at 20°C	In the Air at 30°C
3x10	18,4	680,1	1000	3,08	-	-
3x16	20,6	835,8	1000	1,91	-	-
3x25	23,9	1092,6	1000	1,20	113	104
3x35	26,2	1307,8	1000	0,868	136	128
3x50	29,4	1592,8	1000	0,641	159	152
3x70	34,6	2125,9	1000	0,443	197	194
3x95	38,1	2598,6	500	0,320	236	239
3x120	41,7	3071,2	500	0,253	269	278
3x150	47,6	3843,6	500	0,206	302	316
3x185	52,6	4648,3	250	0,164	342	365
3x240	58,5	5663,9	250	0,125	397	430
3x300	64,6	6896,6	250	0,100	454	506

Nominal Cross Section (mm ²)	Overall Diameter (mm)	Net Weight (kg/km)	Delivery Length (m)	Resistance at 20°C (ohm/km)	Current Carrying Capacity	
					In the Ground at 20°C	In the Air at 30°C
3x16+10	21,5	911,3	1000	1,91 - 3,08	-	-
3x25+16	25,0	1185,7	1000	1,20 - 1,91	113	104
3x35+16	26,9	1375,5	1000	0,868 - 1,91	136	128
3x50+25	30,6	1712,8	1000	0,641 - 1,20	159	152
3x70+35	35,8	2261,7	500	0,443 - 0,868	197	194
3x95+50	39,6	2783,3	500	0,320 - 0,641	236	239
3x120+70	44,4	3444,3	500	0,253 - 0,443	269	278
3x150+70	49,0	4047,8	250	0,206 - 0,443	302	316
3x185+95	54,2	4924,2	250	0,164 - 0,320	342	365
3x240+120	60,2	6027,5	250	0,125 - 0,253	397	430
3x300+150	66,8	7384,4	250	0,100 - 0,206	454	506
3x400+185	75,2	9353,8	250	0,0778 - 0,164	520	575



ISTITUTO ITALIANO DEL MARCHIO DI QUALITÀ

RIZZANI

CAVI

Nominal Cross Section (mm ²)	Overall Diameter (mm)	Net Weight (kg/km)	Delivery Length (m)	Resistance at 20°C (ohm/km)	Current Carrying Capacity	
					In the Ground at 20°C	In the Air at 30°C
4x10	19,8	751,9	1000	3,08	-	-
4x16	22,1	938,6	1000	1,91	-	-
4x25	25,9	1245,5	1000	1,20	113	104
4x35	28,6	1522,0	1000	0,868	136	128
4x50	32,2	1863,7	1000	0,641	159	152
4x70	38,0	2498,2	500	0,443	197	194
4x95	42,4	3132,1	500	0,320	236	239
4x120	46,4	3736,9	500	0,253	269	278
4x150	52,5	4605,8	250	0,206	302	316
4x185	58,6	5659,5	250	0,164	342	365
4x240	64,7	6861,7	250	0,125	397	430
4x300	71,4	8384,5	250	0,100	454	506
4x400	80,6	10686,0	250	0,0778	520	575

Nominal Cross Section (mm ²)	Overall Diameter (mm)	Net Weight (kg/km)	Delivery Length (m)	Resistance at 20°C (ohm/km)	Current Carrying Capacity	
					In the Ground at 20°C	In the Air at 30°C
5x10	21,2	857,2	1000	3,08	-	-
5x16	23,8	1079,3	1000	1,91	-	-
5x25	28,2	1458,8	1000	1,20	113	104
5x35	31,2	1791,8	1000	0,868	136	128
5x50	35,6	2247,0	500	0,641	159	152
5x70	41,7	2958,8	500	0,443	197	194
5x95	46,5	3745,7	500	0,320	236	239
5x120	50,9	4451,8	250	0,253	269	278
5x150	58,3	5569,9	250	0,206	302	316
5x185	64,5	6767,4	250	0,164	342	365
5x240	71,3	8263,8	250	0,125	397	430
5x300	79,3	10216,8	250	0,100	454	506
5x400	89,0	12920,4	250	0,0778	520	575

Note : Current carrying capacities are valid at 30°C ambient temperature.



ISTITUTO ITALIANO DEL MARCHIO DI QUALITÀ